

Indoor Antenna / Antena Interior

Ref. 130583

Operating modes / Modos de funcionamiento



Introduction / Introducción

Televes' Intelligent TV Antenna, does not need to be aimed. Specially designed for OTA (Over-The-Air) signals reception and ready to reject cellular LTE bands (4G/5G) up to channel 36.

An intelligent BOSS system (Balanced Output Signal System) is dynamically adjusted in real time to provide the best TV signal automatically. Developed with our unique TForce technology, it provides exceptionally stable reception within a greater coverage area.

In order to power up the antenna, it is necessary to install the power injector between the antenna and the TV, and power it whether with a PSU, charger or from the USB port of the TV (see figure). In good coverage areas, the antenna can also operate in passive mode (without power).

Antena de TV inteligente que no necesita ser orientada. Diseñada especialmente para la recepción de la Televisión Digital Terrestre y preparada para rechazar las interferencias de la telefonía móvil hasta el canal 36.

Su sistema inteligente BOSS (Balanced Output Signal System) se ajusta en tiempo real para ofrecer siempre la mejor señal de TV de forma automática. Desarrollada con la exclusiva tecnología TFORCE, presenta una recepción muy estable y con la mejor área de cobertura.

Para alimentar la antena es necesario intercalar el inyector de corriente entre la antena y la TV, y alimentarlo con un cargador o desde el puerto USB de la TV (ver el esquema). En zonas de buena cobertura, la antena también puede funcionar en modo pasivo (sin alimentación).

Content / Contenido





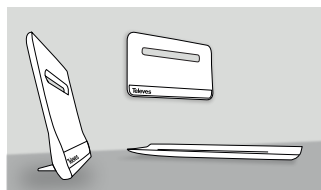

Antenna positions / Posiciones de la antena

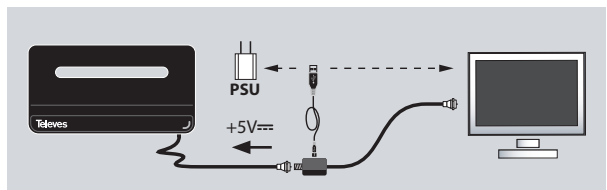

Options for powering the antenna / Opciones para alimentar la antena

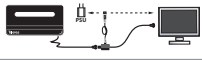

Technical specifications / Características técnicas

Ref.		130583		
←...MHz→	MHz	Low VHF (CH2 - CH6)	High VHF (CH7 - CH13)	UHF (CH14 - CH36)
		54 ... 88	174 ... 216	470 ... 608
G▷ (1)	dBi	17	26	28
	Local (USB)	V= mA	5 80	
			IP20	
		lb / g	1.05 / 475	
		in / mm	12.6" x 6.81" x 0.76" / 320 x 173 x 19.3	

(1) Automatic regulation of the gain in intelligent mode (powered antenna) / Autorregulación de la ganancia en modo inteligente (antena alimentada).

Important safety instructions

General installation conditions

- Before handling or connecting the equipment, please read this manual.
- Do not open the antenna without disconnecting it from the power supply.
- The equipment must not come into contact with water or even be splashed by liquids. Do not place containers with water on or near the equipment if it is not adequately protected.
- Do not place the equipment near sources of heat or in excessively moisture conditions.
- Do not place naked flames, such as lighted candles on or near the product.
- Do not place the equipment where it may be affected by strong vibrations or knocks.
- Clean only with a dry cloth.
- Only use attachments /accessories specified by the manufacturer.
- Ambient temperature should not be higher than 45°C.

How to use equipment safely

- The antenna is powered by a power injector connected to a PSU, charger or to the USB port on the TV.
- If any liquid or object falls inside the AC adapter, replace it with a new one or contact an authorized repair center.

Importantes instrucciones de seguridad

Condiciones generales de instalación

- Antes de manipular o conectar el equipo leer este manual.
- No quitar la tapa del equipo sin desconectarlo de la alimentación.
- El equipo no debe ser expuesto a caídas o salpicaduras de agua. No situar objetos o recipientes llenos de agua sobre o cerca del aparato si no se tiene la suficiente protección.
- No situar el equipo cerca de fuentes de calor o en ambientes de humedad elevada.
- No situar sobre el aparato fuentes de llama desnuda, tales como velas encendidas.
- No situar el equipo donde pueda estar sometido a fuertes vibraciones o sacudidas.
- Limpie la unidad sólo con un paño seco.
- Utilice solamente los aditamentos / accesorios especificados por el fabricante.
- La temperatura ambiente no debe superar los 45°C.

Operación segura del equipo

- La antena se alimenta mediante el inyector de corriente conectado a un cargador/PSU o al conector USB de la TV.
- Si algún líquido u objeto se cayera dentro del equipo, por favor recurra al servicio técnico especializado.

Description of the symbols Descripción de simbología		Equipment designed for indoor use. Equipo diseñado para uso en interiores.
-----------------------------------------------------------------------	-----------------------------------------------------------------------------------	-------------------------------------------------------------------------------

Televés Limited Warranty

Televés S.A.U. warrants this product against any defects in materials or workmanship within 90 (ninety) days from the date of purchase. No warranty claim will be honored unless at the time the claim is made, you present proof of purchase to an authorized Televés dealer (if unknown, please contact Televés USA LLC, Norfolk Tech Center 16596 E. 2nd Avenue Aurora, CO 80011 (USA) - Tel: +1 (720) 379-3748.

Televés (at its sole discretion) will either repair or replace the defective product at no charge. This warranty covers parts, but does not cover any costs incurred in removal, shipping or reinstallation of the product. This limited warranty does not apply if the product is damaged, deteriorates, malfunctions or fails from misuse, improper installation, abuse, neglect, accident, tampering, modification of the product as originally manufactured by Televés, usage not in accordance with product instructions or acts of nature such as damage caused by wind, lightning, ice or corrosive environments such as salt spray and acid rain.

The 90 day warranty is provided on the condition that the equipment is properly delivered with all handling and freight charges prepaid to your Televés dealer for return to our factory for repair or replacement. Televés will arrange for the replacement or repair and return without charge the product which failed due to defective material or workmanship.

Televés will not assume any liabilities for any other warranties, express or implied, made by any other person.

All other warranties whether express, implied or statutory including warranties of fitness for a particular purpose and merchantability are limited to the 90-day period of this warranty.

The foregoing shall be the sole and exclusive remedy of any person, whether in contract, tort or otherwise, and Televés shall not be liable for incidental or consequential damage or commercial loss, or from any other loss or damage except as set forth above.

Some states do not allow limitations on how long an implied warranty lasts, or the exclusion of limitation of incidental or consequential damages, so the above limitations or exclusions may not apply to you.

This warranty gives you specific legal rights and you may also have other rights which vary from state to state.

Televés and BEXIA are registered trademarks of Televés S.A.U. All trademarks are property of their respective owners.

Televés USA LLC. Norfolk Tech Center 16596 E. 2nd Avenue Aurora, CO 80011 (USA)
 televés.usa@televés.com www.televés.com

